



The All-New CM LP comes packed with all the latest features, smaller size with bigger capacity. Less floor clearance required, perfect for tiny houses and small spaces.

Australian Designed and Assembled

Specialised Design for Tiny Home

Specification

Capacity	1-2 people on a permanent basis
Power usage	12 Volt 5 Watt
Floorspace Required	Clearance below floor: † 450 mm
Dimensions	630 (740 incl. handles) W 450 H mm 65 Litres capacity
Chute Length	550 mm
Materials	Stabilised LDPE materials
Water Consumption	Waterless
Solar Options	✓
Warranty ROTOMOULDED COMPONENT	10 years warranty



What will you get?

CM LP standard package includes:

- 2 x composting chambers with composter mixers
- Premium porcelain pedestal with soft close seat
- Waste connecting chute (up to 550 mm in length as standard but can be shortened if required).
- Ventilation system including a 12 volt 2 watt fan and transformer*
- 2 x Nature Quick Microbe starter bags
- 1 x 125ml Nature Flush Enzymes & spray bottle
- 2 x Bags of bulking agent
- Easy to follow DIY Installation and Maintenance manual

*If the transformer is not required, it will be replaced with a spare fan.

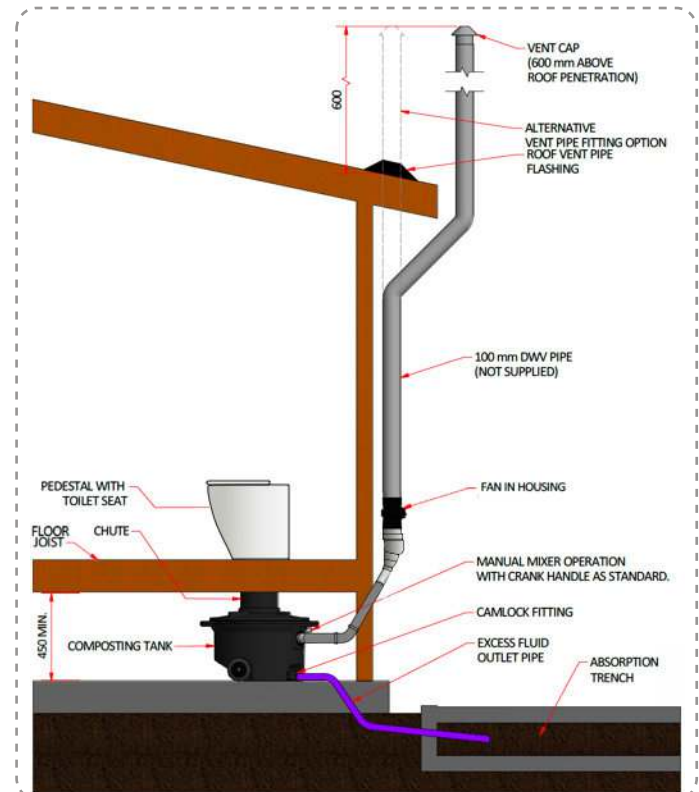

Side Profile of CM LP



Space saving



Save water



No plumbing



Solar available



Sustainable disposal



Complete solution

Get in Touch

08 9758 8640

info@waterwally.com.au
www.waterwally.com.au